

# PORTABLE BASKETBALL SYSTEM

## .INSTRUCTION.

**ZY-080**

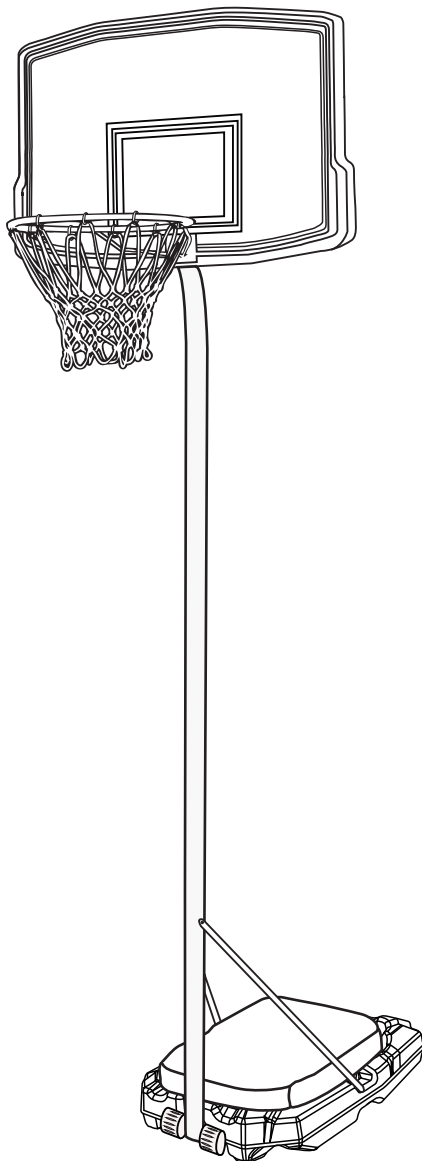

# PREPARATION

## PLEASE READ THIS PAGE CAREFULLY

Remove all parts and hardware from the carton and place them on a clean soft surface. Check carefully to make sure nothing is missing. Dispose of all packaging materials properly. Please recycle.



## SAFETY INSTRUCTIONS



**FAILURE TO FOLLOW THESE SAFETY INSTRUCTIONS MAY RESULT IN SERIOUS INJURY OR PROPERTY DAMAGE AND WILL VOID WARRANTY.**

*Owner must ensure that all players know and follow these rules for safe operation of the system.*

To ensure safety, do not attempt to assemble this system without following the instructions carefully. Check entire box and inside all packing material for parts and/or additional instruction material. Before beginning assembly, read the instructions and identify parts using the hardware identifier and parts list in this document. Proper and complete assembly, use, and supervision are essential for proper operation and to reduce the risk of accident or injury. A high probability of serious injury exists if this system is not installed, maintained, and operated properly.

- If using a ladder during assembly, use extreme caution.
- Check base regularly for leakage. Slow leaks could cause the system to tip over unexpectedly
- Seat the pole sections properly (if applicable). Failure to do so could allow the pole sections to separate during play and/or during transport of the system.
- Climate, corrosion or misuse could result in system failure.
- If technical assistance is required, contact Customer Service.
- Minimum operational height is 6' 6" (1.98m) to the bottom of backboard.

*Most injuries are caused by misuse and/or not following instructions.*

*Use caution when using this unit.*



## WARNING



- Manufacturer recommends filling the base with sand, not water. If you choose to use water, ALWAYS check for leaks. Leaking water will lighten the base and cause the system to become unstable and tip over.
- Empty water completely from the base, or add 2 gallons (7.57 liters) of anti-freeze, before the temperature approaches or falls below the freezing point. Freezing water may crack the base and cause leaks. This will result in failure of the system, and could result in serious injury.
- For residential use only! NOT for commercial use! DO NOT use this product for other than its intended purpose. Any commercial, public, or institutional use voids all warranties.

**A** Backboard

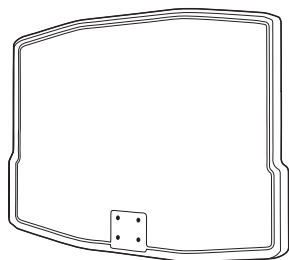

x1

**B** Rim/Net



x1



B-1

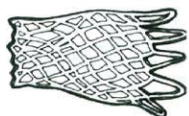

B-2

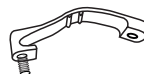

B-3

**C** Base

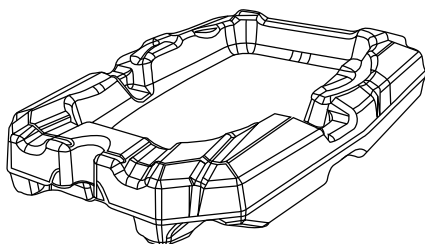

x1

**D** Bottom Pole



x1

**E** Middle Pole



x1

**F** Top Pole



x1

**G** Support arm

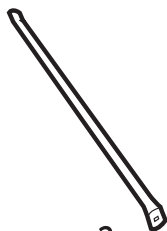

x2

**H** Axle  
8 x 120mm



x1

**I** Axle  
10 x 180mm

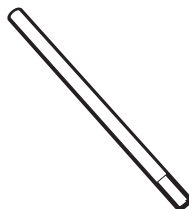

x1

**J** Wheel

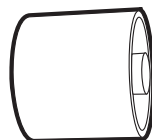

x2

**K** Top Pole

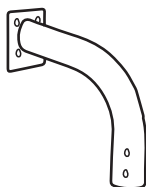

x1

**L** Triangle Nut



x1

**M** Base Cap



x1

**N** Sand Bag

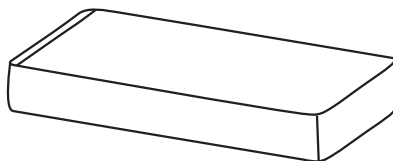

**L** Lock Nut  
M 8



x8

**P** Washer  
M 8



x14

M8 x 20mm



**1**

x2

M8 x 30mm



**2**

x4

M8 x 65mm

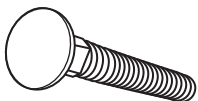

**3**

x1

M8 x 60mm

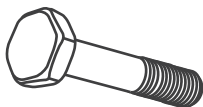

**4**

x1

M8 x 50mm

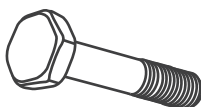

**5**

x1

M5 x 16mm



**6**

x1

## Assembly Required

Adjustable Spanner  
Adjustable Wrench

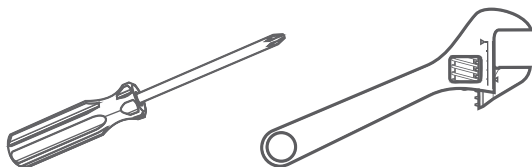

Wrenches

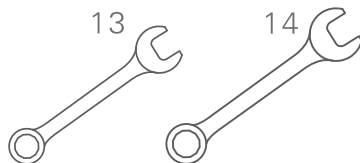

## Do...

Keep your face and mouth away from the rim and net during play. If your teeth or face come into contact with the rim and net, serious injury can occur.

When adjusting the height or moving the system, keep your fingers and hands away from the moving parts.

Ensure the surface beneath the base is flat and free of stones, gravel, or any other debris which may puncture the base. If leakage occurs the system may topple over.

Check system before each use for loose fittings, wear and tear or any other signs of instability. Tighten any loose fittings.

Keep water and organic material away from the pole. The pole could rust and fall.

Once a month check the pole and all metal parts for rust.

## Do Not...

Do not hang from the rim.

Do not wear jewellery during play, it may become entangled with the net.

Do not slide or climb onto the base or pole.

Do not leave the system standing upright without having filled the base with water or sand.

Do not allow children to adjust the height or move the system.

Do not use the system in windy or severe weather conditions. System may tip over. Place system in an area protected from the wind or in an area away from property that may be damaged if the system falls.

Do not use near overhead power lines.

Do not hang anything off the rim or backboard and do not use the system to lift or hoist anything.

# STEP 1

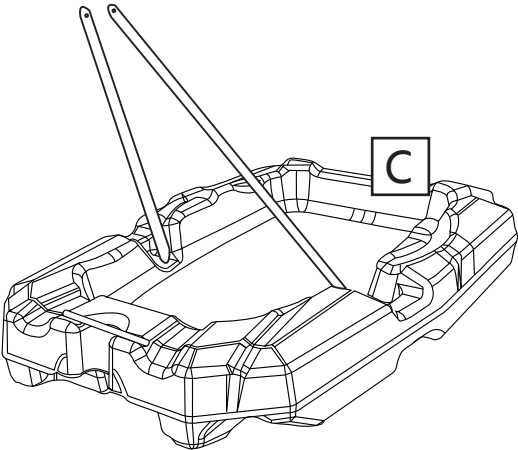
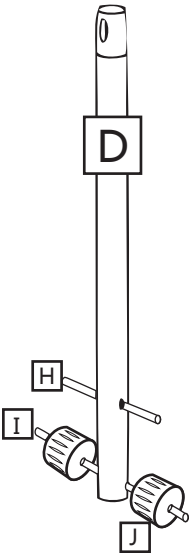
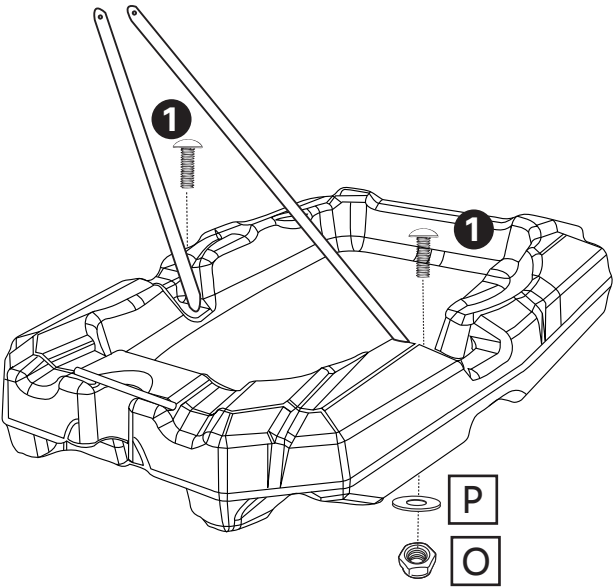

# STEP 2

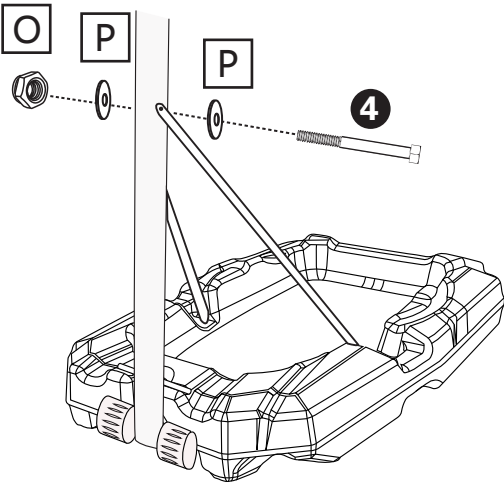
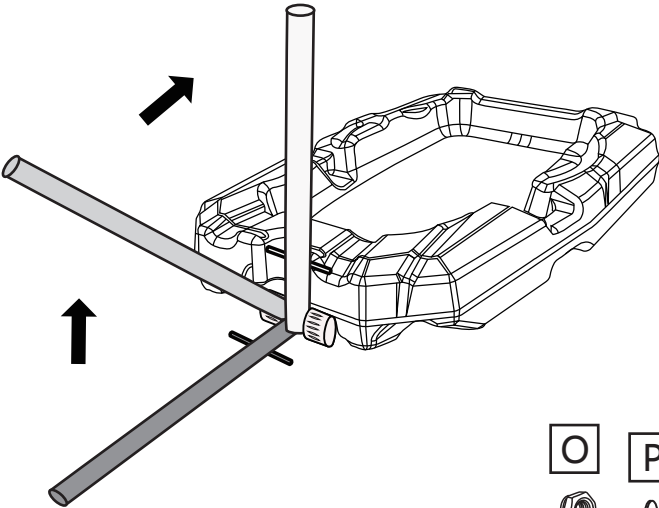
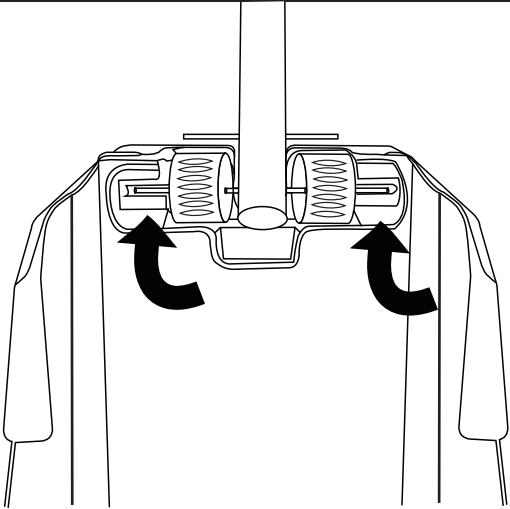

STEP 3

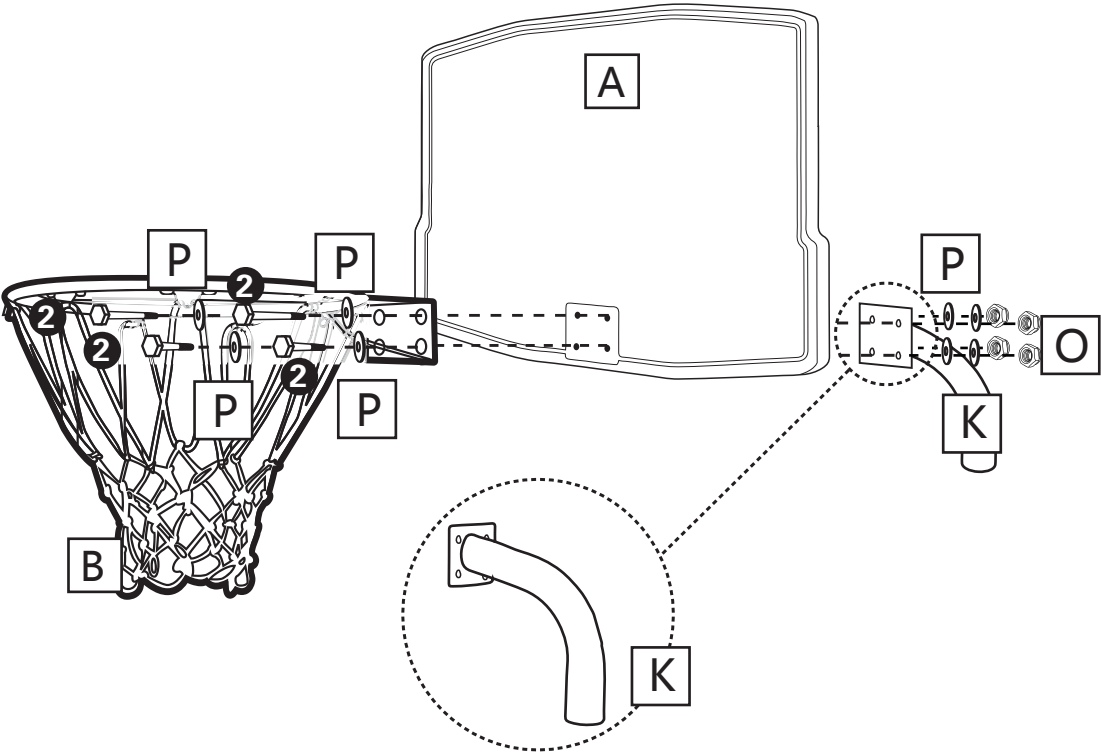
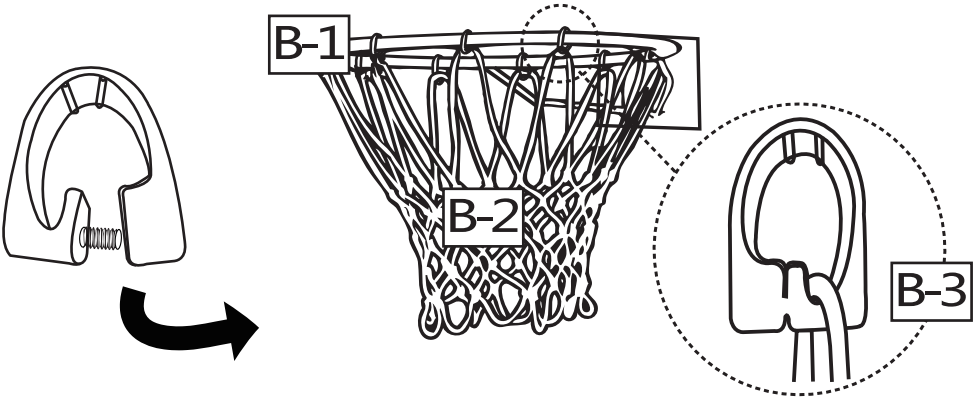

# STEP 4

## DO IT FIRST!

Insert the top pole up inside the upper middle pole so that it protrudes from the top.

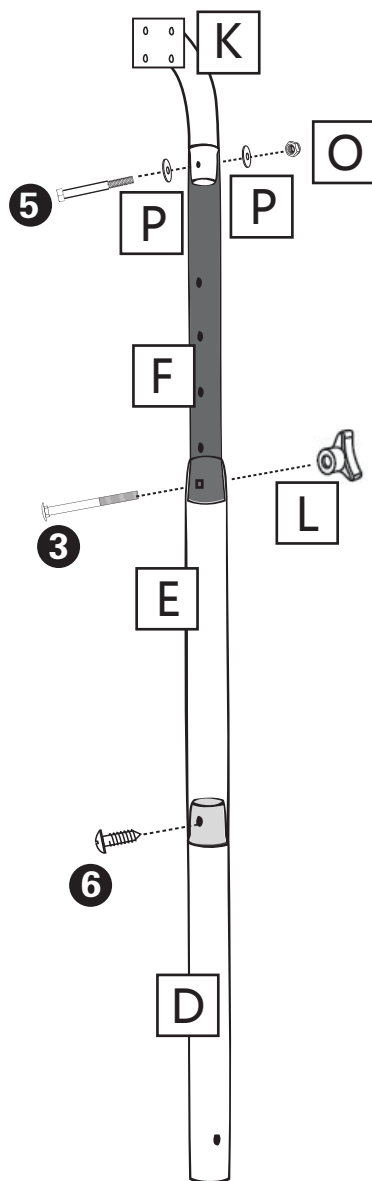
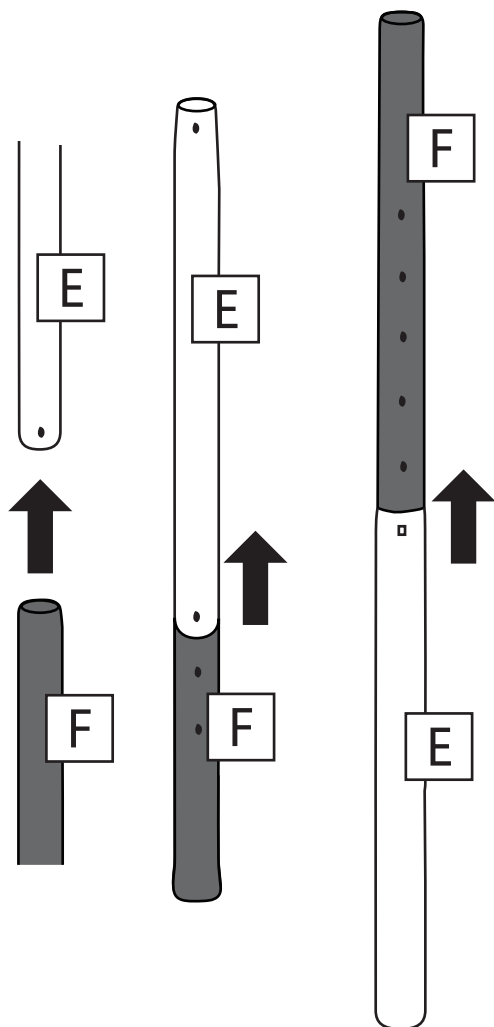

# STEP 5



## Warning



- Two capable adults required for this step.
- NEVER leave system in upright position without proper weight in base or the system will tip over.
- Manufacturer recommends using sand.

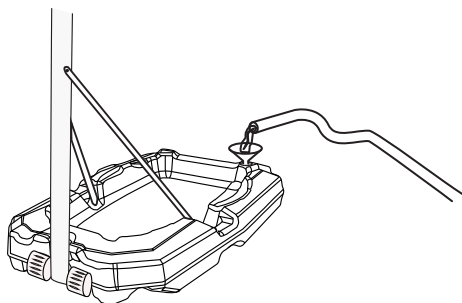
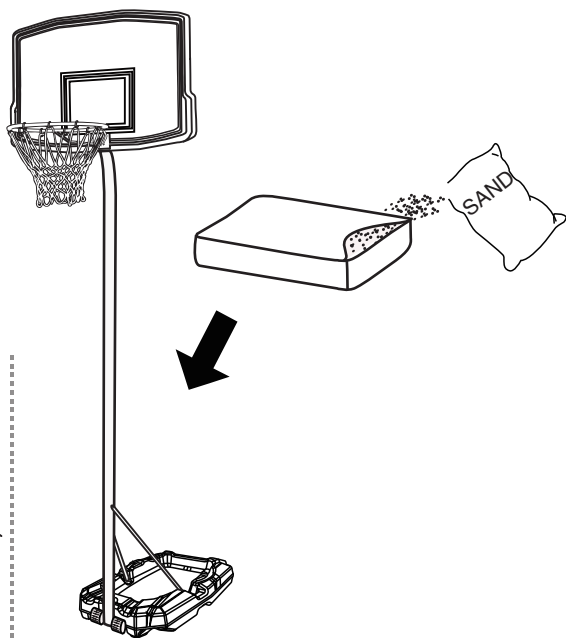

1. Adjust backboard to lowest position.
2. While holding pole and lifting base, carefully lean system forward until wheels touch ground.
3. While holding pole and base, roll system to desired location.
4. Stand pole upright and set base flat on ground.
5. ALWAYS check to make sure system is stable in new location.

